

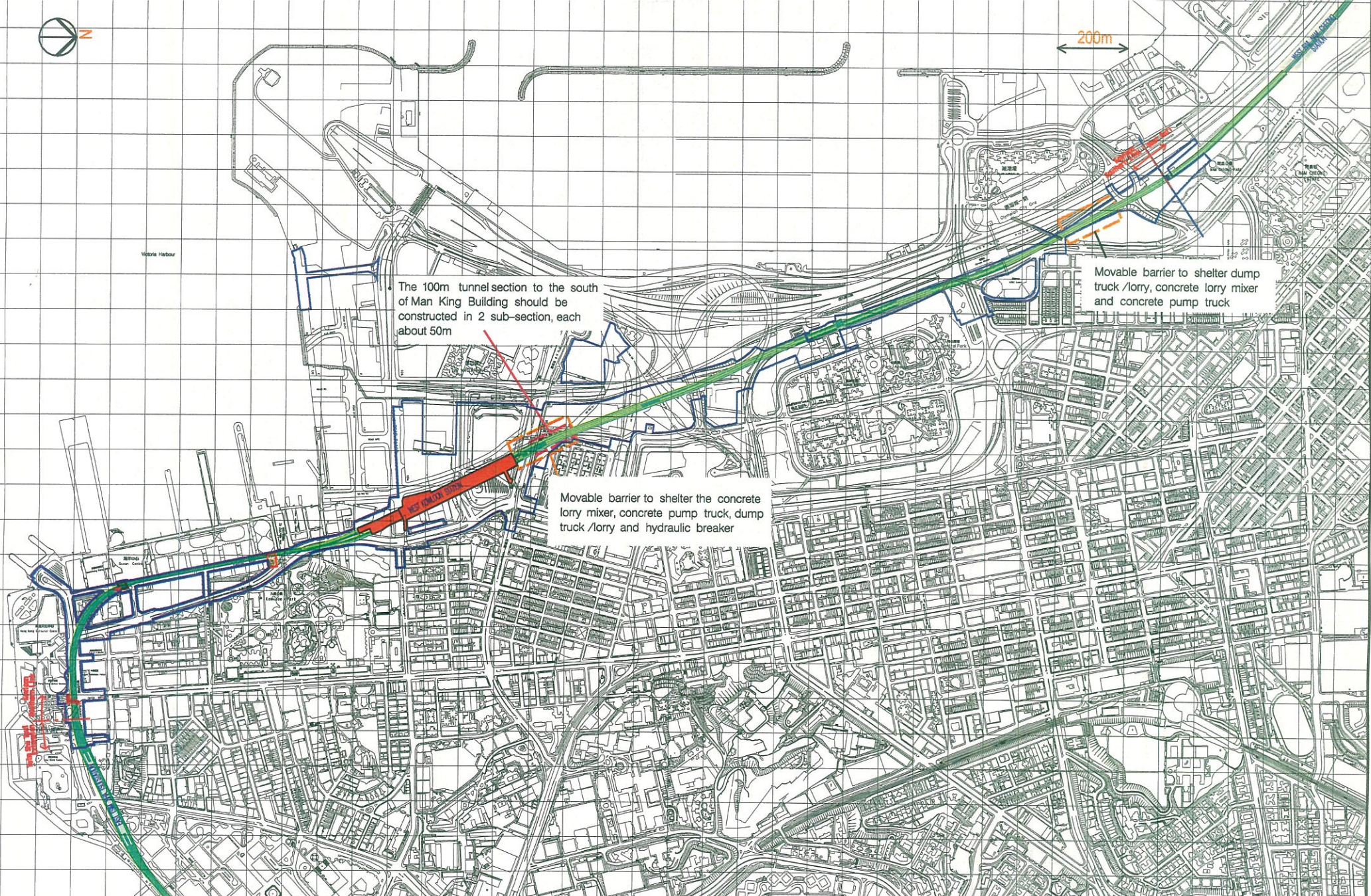

200m



The 100m tunnel section to the south of Man King Building should be constructed in 2 sub-section, each about 50m

Movable barrier to shelter dump truck / lorry, concrete lorry mixer and concrete pump truck

Movable barrier to shelter the concrete lorry mixer, concrete pump truck, dump truck / lorry and hydraulic breaker

FILENAME: G:\www\proj\123573\Drawings\3rd\EA-18\Figures\APPENDIX-2.dgn
 Maps reproduced with permission of The Director of Lands, (C) Hong Kong Government.

REV	DATE	BY	SUB	APP	DESCRIPTION
△	DEC2003	SW	FC	ST	EIA REPORT
△	NOV2003	SW	FC	ST	EIA REPORT
△	JUNE2003	SW	FC	ST	EIA REPORT
△	7MAR2003	SW	FC	ST	EIA REPORT (2ND DRAFT)
△	11OCT2002	SW	FC	ST	EIA REPORT (1ST DRAFT)

DESIGNED BY	SW
DRAWN BY	JF
CHECKED BY	FC
IN CHARGE	ST
DATE	5 DEC 2003



New Railway Projects
新鐵路策劃

Ove Arup & Partners Hong Kong Limited



KOWLOON SOUTHERN LINK KSL GSA-5100
EIA & ASSOCIATED SERVICES

SPECIFIC MITIGATION MEASURES FOR PARTICULAR PILES AT WORKSITES IN FRONT OF MAN KING BUILDING AND OLYMPIAN CITY PHASE 3

DRAWING NUMBER	1:10000 @ A3
STAGE CODE	P
REV	E
FIGURE NUMBER	FIGURE A 14-2